

1/10 SCALE EP OFF-ROAD 2WD BUGGY **GRIFFIN** SPARE & TUNING PARTS DIAGRAM

ACADEMY
HOBBY MODEL KITS

SPARE PART

GRS-1 Main chassis
메인 샴시

₩15,000

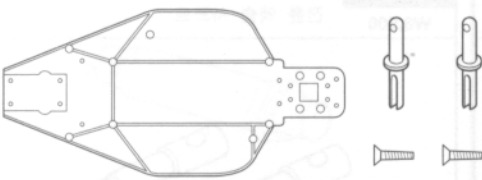

- Chassis 샴시 × 1
- #3×12 F/H Tapping screw 비스 × 2
- Battery strap post × 2
- 배터리 스트랩 포스트

GRS-2 Gear box
기어 박스

₩5,000

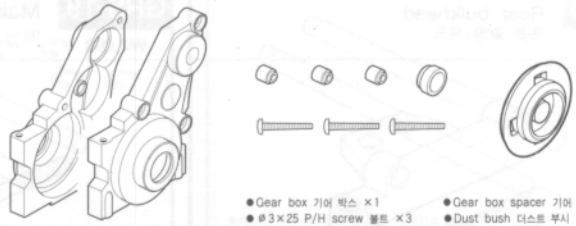

- Gear box 기어 박스 × 1
- #3×25 P/H screw 볼트 × 3
- Gear box spacer 기어 박스 스페이스 × 3
- Dust bush 더스트 부시 × 1
- Gear cover cap 기어 커버 캡 × 1

GRS-3 Gear diff. case
기어 디프 케이스

₩3,000



- Gear case(L,R) 기어 케이스(좌우) × 1
- Diff. gear 디프 기어 × 1
- #2×14 P/H Tapping screw 탭핑 비스 × 4
- Bearing bush 베어링 부시 × 2

GRS-4 Inner gear
내부 기어

₩2,500

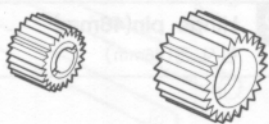

- Top gear 탑 기어 × 1
- Center gear 중간 기어 × 1

GRS-5 Spur gear
스퍼 기어

₩2,500

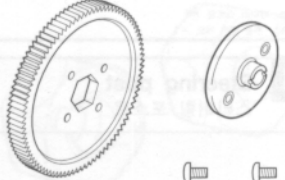

- Spur gear 스피어 기어 × 1
- Spur gear adapter 스피어 기어 어댑터 × 1
- #3×5 P/H screw 볼트 × 2

GRS-6 Rear arm mount
후륜 암 마운트

₩2,500

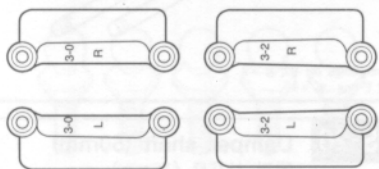

- Rear arm mount (3-0) 암 마운트(3-0) × 1
- Rear arm mount (3-2) 암 마운트(3-2) × 1

GRS-7 Front bulkhead
전륜 벌크헤드

₩2,500

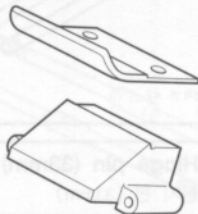

- Front bulkhead 전륜 벌크헤드 × 1
- Bumper 범퍼 × 1

GRS-8 servo saver
서어보 세이버

₩2,500



- Servo mount × 2
- 서어보 마운트
- Servo horn × 1
- 서어보 혼
- Servo saver × 1조
- 서어보 세이버
- Injection bush × 1
- 사출 부시
- Damper spacer × 1
- 댐퍼 스페이스
- Speed controller mount × 1
- 변속기 마운트

GRS-9 Front/Rear arm
전/후륜 암

₩3,000



- Front arm 전륜 암 × 2
- Rear arm 후륜 암 × 2

GRS-10 Knuckle arm
너클 암

₩2,000

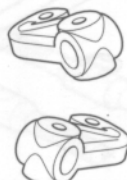

- Knuckle arm 너클 암 × 2

GRS-11 Front hub
전륜 허브

₩2,000

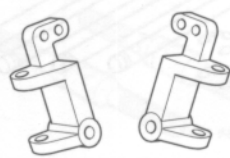

- Front hub L/R 전륜 허브(좌우) × 1

GRS-12 Rear hub
후륜 허브

₩2,000

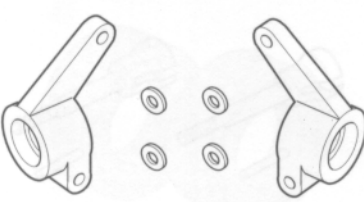

- Rear hub 후륜 허브 × 2
- Hub spacer 허브 스페이스 × 4

GRS-13 Front damper stay
전륜 댐퍼 스테이

₩2,500

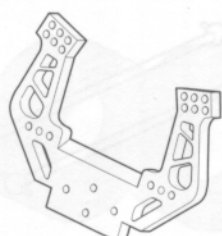

- Front damper stay 전륜 댐퍼 스테이 × 1

GRS-14 Rear damper stay
후륜 댐퍼 스테이

₩3,000



- Rear damper stay 후륜 댐퍼 스테이 × 1

GRS-15 Nose plate**₩4,000**

노즈 플레이트

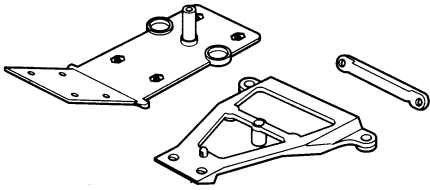

- Nose plate 노즈 플레이트 x1
- Top plate 탑 플레이트 x1
- Hinge pin bracer 힌지 핀 브레이서 x1

GRS-16 Front wheel (white)**₩3,500**

전륜 휠 (백색)

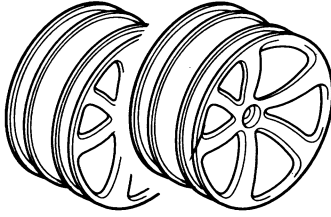

- Front wheel 전륜 휠 x2

GRS-17 Rear wheel (white)**₩3,500**

후륜 휠 (백색)

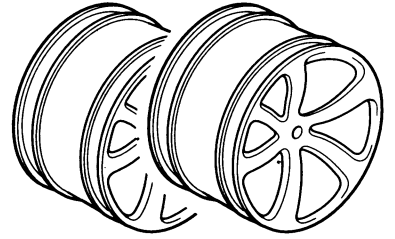

- Rear wheel 후륜 휠 x2

GRS-18 Rear bulkhead**₩2,500**

후륜 벌크 헤드

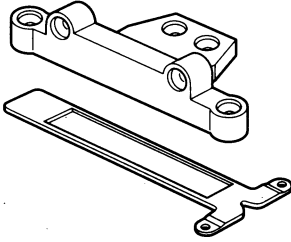

- Battery strap 배터리 스트랩 x1
- Rear bulkhead 후륜 벌크 헤드 x1

GRS-19 Main shaft**₩3,000**

메인 샤프트

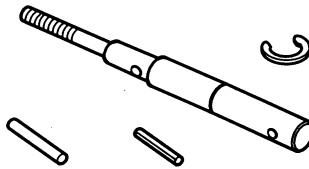

- Main shaft 메인 샤프트 x1
- C-stop ring 스톱 링 x1
- $\phi 1.5 \times 6$ spring pin 스프링 핀 x1
- $\phi 2 \times 8.8$ pin 핀 x1

GRS-20 Front axle shaft**₩3,000**

전륜 액슬 샤프트

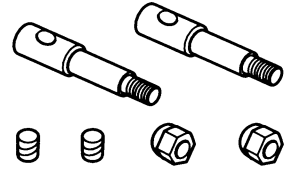

- Front axle shaft 전륜 액슬 샤프트 x2
- $\phi 4$ nylon nut 나일론 너트 x2
- $\phi 3 \times 3$ Set screw 육각 볼트 x2

GRS-21 Steering post**₩4,000**

스티어링 포스트

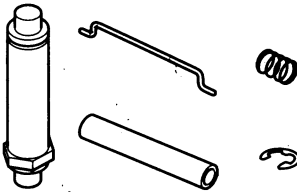

- Steering Post(A) 스티어링 포스트 x1
- Steering Post(B) 스티어링 포스트 x1
- $\phi 5$ E-ring 링 x1
- Saver spring 세이버 스프링 x1
- Steering rod 스티어링 로드 x1

GRS-22 Hinge pin(46mm)**₩1,000**

힌지 핀 (46mm)

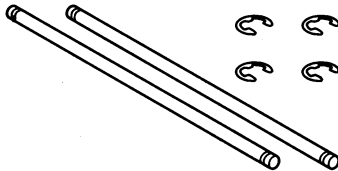

- 46mm hinge pin 힌지 핀 x2
- $\phi 2$ E-ring 링 x4

GRS-23 Hinge pin(40mm)**₩1,000**

힌지 핀 (40mm)

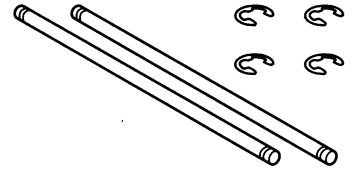

- 40mm hinge pin 힌지 핀 x2
- $\phi 2$ E-ring 링 x4

GRS-24 Hinge pin (26.5mm)**₩2,000**

힌지 핀 (26.5mm)

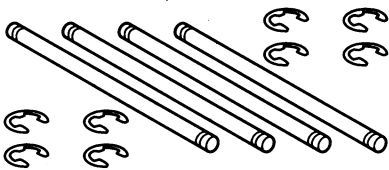

- 26.5mm hinge pin 힌지 핀 x4
- $\phi 2$ E-ring 링 x8

GRS-25 Hinge pin (33mm)**₩1,000**

힌지 핀 (33mm)

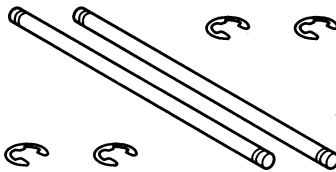

- 33mm hinge pin 힌지 핀 x2
- $\phi 2$ E-ring 링 x4

GRS-26 Damper shaft (50mm)**₩1,500**

댐퍼 샤프트 (50mm)

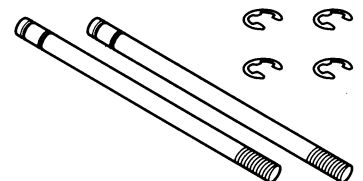

- 50mm damper shaft 댐퍼 샤프트 x2
- $\phi 2.5$ E-ring 링 x4

GRS-27 Damper shaft (39mm)**₩1,500**

댐퍼 샤프트 (39mm)

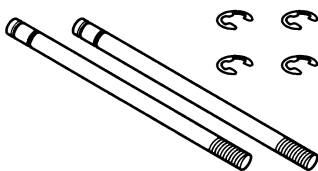

- 39mm damper shaft 댐퍼 샤프트 x2
- $\phi 2.5$ E-ring 링 x4

GRS-28 Drive shaft**₩3,500**

드라이브 샤프트

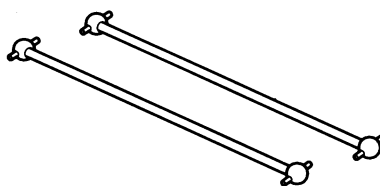

- Drive shaft 드라이버 샤프트 x2

GRS-29 Axle shaft**₩4,000**

액슬 샤프트

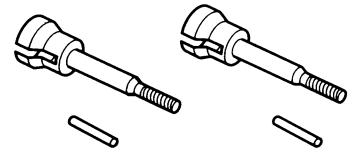

- Axle shaft 액슬 샤프트 x2
- $\phi 2.5 \times 8.5$ Pin 핀 x2

GRS-30 Rod (50mm)
₩2,000 로드 (50mm)

● 50mm rod 로드 × 4

GRS-31 Rod (65mm)
₩1,000 로드 (65mm)

● 65mm rod 로드 × 2

GRS-32 Ø 4.3 pin ball
₩2,500 Ø 4.3 핀볼

● Ø 4.3 pin ball 핀볼 × 10

GRS-33 Gear cover
₩1,000 기어 커버

● Gear cover 기어 커버 × 1

GRS-34 18T pinion gear
₩2,000 18T 피니언 기어

● 18T pinion gear 피니언 기어 × 1
 ● #3×3 set screw 축각볼트 × 1

GRS-35 Front tire
₩3,500 전륜 타이어

● Front tire 전륜 타이어 × 2

GRS-36 Rear tire
₩4,500 후륜 타이어

● Rear tire 후륜 타이어 × 2

GRS-37 Sticker
₩5,000 스티커

● Griffin Sticker 그리핀 스티커 × 1

GRS-38 Neo Griffin Sticker
₩6,000 네오 그리핀 스티커

● Neo Griffin Sticker 네오 그리핀 스티커 × 1

TUNING PART

GRT-1 Ball diff. set
₩22,000 볼 디프 셋트

● Ball diff. gear 볼 디프 기어 × 1
 ● Thrust washer 트러스트 와셔 × 2
 ● #2.5 Diff. ball 디프 볼 × 12
 ● 850 Oilless metal bearing 오일리스 메탈 베어링 × 2
 ● Ball diff. joint cap(A,B) 볼디프 조인트 캡 × 1
 ● Diff. spring 디프 스프링 × 1
 ● #1.5 Thrust ball 트러스트 볼 × 9
 ● Ball diff. washer 볼디프 와셔 × 2
 ● #3×28 Cap screw 캡 스크류 × 1
 ● Silicon grease 실리콘 그리스 × 1
 ● Injection nut 사출 너트 × 1

GRT-2 Slipper clutch set
₩12,000 슬리퍼 클러치 셋트

● Slipper disk A,B × 1
 ● 슬리퍼 디스크
 ● Teflon slipper pad × 1
 ● 테프론 슬리퍼 패드
 ● Thrust washer 트러스트 와셔 × 2
 ● #3 Nylon nut 나일론 너트 × 1
 ● Spur spring 스퍼 스프링 × 1
 ● #3×5 P/H screw 볼트 × 2
 ● #1.5 Thrust ball 트러스트 볼 × 9

GRT-3 Universal shaft
₩17,000 유니버설 샤프트

● Universal shaft 유니버설 샤프트 × 2
 ● Wheel hub 휠 허브 × 2
 ● #2.5×8.5 Pin 핀 × 2

GRT-4 Turnbuckle (65mm)
₩2,500 턴버클 (65mm)

● 65mm turnbuckle 턴버클 × 2

GRT-5 Slipper disk
₩10,000 슬리퍼 디스크

● Slipper disk A,B 슬리퍼 디스크 × 1
 ● #3×5 P/H screw 볼트 × 2

GRT-6 Ball diff. joint cup
볼 디프 조인트 컵
₩13,000

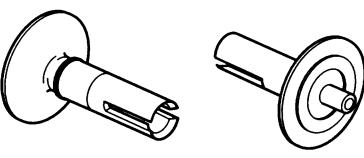

● Ball diff. joint cup A,B 볼디프 조인트 컵 ×1

GRT-7 Ball diff. gear
볼 디프 기어
₩2,500

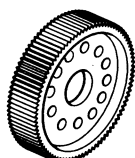

● Ball diff. gear 볼디프 기어 ×1

GRT-8 Motor mount (purple)
모터 마운트 (퍼플)
₩5,000

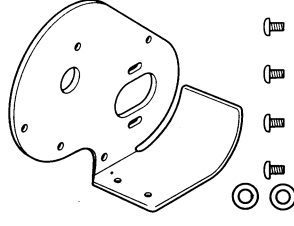

● Motor mount 모터 마운트 ×1
● 3×8 Washer 와셔 ×2
● #3×5 P/H screw 볼트 ×4

GRT-9 Polycarbonate body
폴리카보네이트 바디
₩9,000

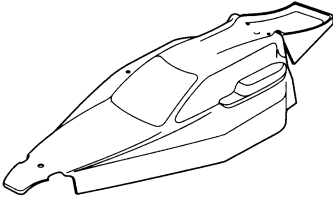

● P.C body 바디 ×1

GRT-10 Ball diff. screw
디프용 캡 스크류
₩2,000

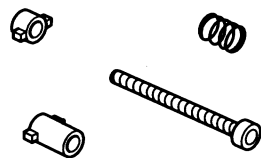

● Injection cap 사출 캡 ×1
● #3×28 Cap screw 캡 스크류 ×1
● Diff. spring 디프 스프링 ×1

GRT-11 Front soft tire
전륜 소프트 타이어
₩4,500

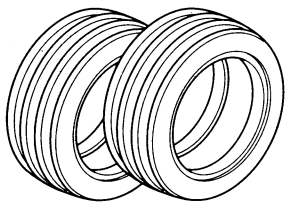

● Front soft tire 전륜 소프트 타이어 ×2

GRT-12 Rear soft tire
후륜 소프트 타이어
₩5,500

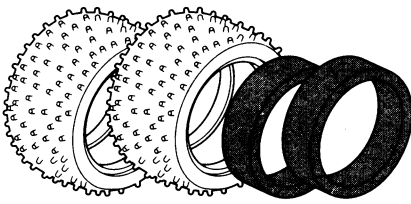

● Rear soft tire 후륜 소프트 타이어 ×2
● Inner form 인너폼 ×2

GRT-13 Front wheel (Flu. yellow)
전륜 휠 (형광 노랑)
₩3,500

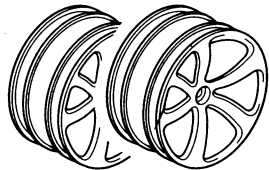

● Front wheel 전륜 휠 ×2

GRT-14 Rear wheel (Flu. yellow)
후륜 휠 (형광 노랑)
₩4,500

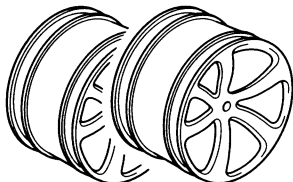

● Rear wheel 후륜 휠 ×2

GRT-15 Front oil damper (purple)
전륜 오일댐퍼 (퍼플)
₩12,000

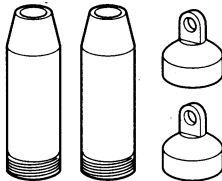

● Front oil damper 전륜 오일댐퍼 ×2
● Damper cap 댐퍼 캡 ×2

GRT-16 Rear oil damper (purple)
후륜 오일댐퍼 (퍼플)
₩13,000



● Rear oil damper 후륜 오일댐퍼 ×2
● Damper cap 댐퍼 캡 ×2

GRT-17 Griffin pro sticker
그리핀 프로 스티커
₩6,000



● Griffin pro sticker 그리핀 프로 스티커 ×1

GRT-18 Pro damper set
프로 댐퍼 셋트
₩2,500

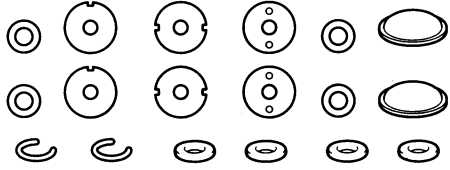

● Piston set 피스톤 셋트 ×1
● Silicon O-ring 실리콘 O-링 ×4
● Rubber cap 러버 캡 ×2
● C-링 링 ×2

GRT-19 Al. spur gear adapter
알루미늄 스퍼 기어 어댑터
₩3,000



● Aluminum spur gear adapter 알루미늄 스퍼 기어 어댑터 ×1
● #1.5×6 Spring pin 스프링 핀 ×1
● #3×5 P/H Screw 볼트 ×2

GRT-20 Silver ball diff. spring
실버 볼디프 스프링
₩1,000

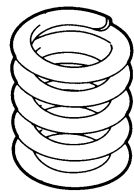

● Silver ball diff. spring 실버볼 디프 스프링 ×1

GRT-21 Poly carbonate body (neo)
바디 (네오)
₩10,000

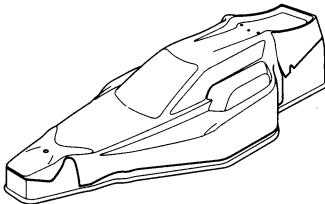

● P.C Body 바디 ×1

GRT-T01 Al. Top gear main shaft
알루미늄 탑기어 메인 샤프트
₩7,000

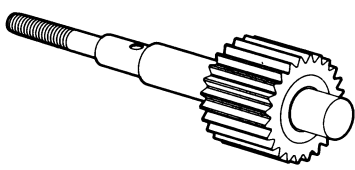

● Top gear main shaft 탑기어 메인 샤프트 ×1

GRT-T02 Manufacturing Center gear
절삭가공 센터 기어
₩2,500

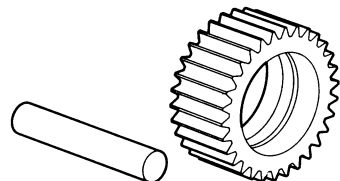

● Center gear 센터 기어 ×1
● Center gear shaft 센터 기어 샤프트 ×1

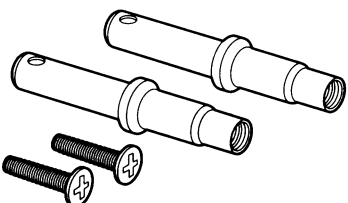
GRT-T03 Al. Battery strap post (purple)
₩3,000 알루미늄 배터리 스트랩 포스트 (퍼플)

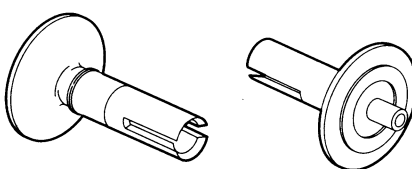
 ● Battery strap post 배터리 스트랩 포스트 ×2
 ● # ×12 F/H screw 볼트 ×2

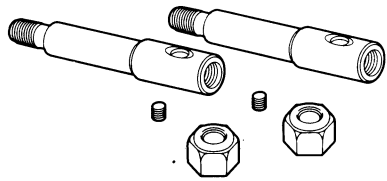
GRT-T04 Al. ball diff. hub
₩13,000 알루미늄 볼 디프 허브

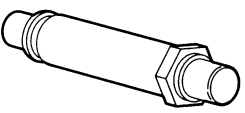
 ● Aluminum ball diff. 알루미늄 볼 디프 ×2

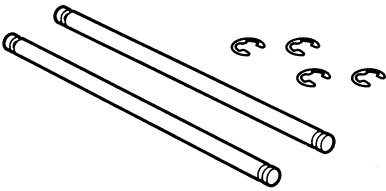
GRT-T05 Al. front axle (purple)
₩4,000 알루미늄 프론트 액슬 (퍼플)

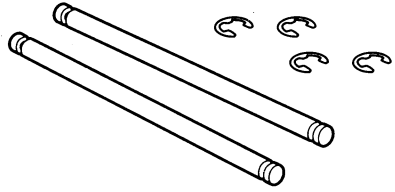
 ● Aluminum front axle 알루미늄 프론트 액슬 ×2
 ● #3×3 Set screw 육각 볼트 ×2
 ● #4 Nylon nut 나일론 너트 ×2

GRT-T06 Al. steering post (purple)
₩3,000 알루미늄 스테어링 포스트 (퍼플)

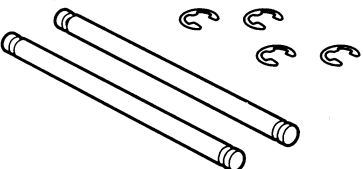
 ● Aluminum steering post 알루미늄 스테어링 포스트 ×1

GRT-T07 Al. hinge pin (46mm)
₩3,000 알루미늄 힌지 핀 (46mm)

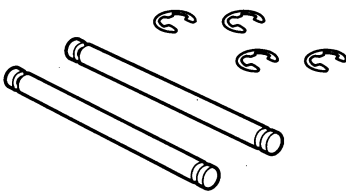
 ● 46mm Aluminum hinge pin 알루미늄 힌지 핀 ×2
 ● #2 E-ring 링 ×4

GRT-T08 Al. hinge pin (40mm)
₩3,000 알루미늄 힌지 핀 (40mm)

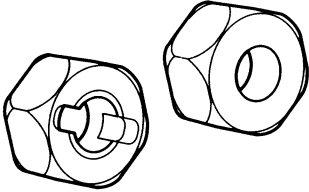
 ● 40mm Aluminum hinge pin 알루미늄 힌지 핀 ×2
 ● #2 E-ring 링 ×4

GRT-T09 Al. hinge pin (33mm)
₩2,500 알루미늄 힌지 핀 (33mm)

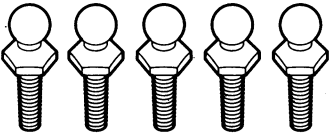
 ● 33mm Aluminum hinge pin 알루미늄 힌지 핀 ×2
 ● #2 E-ring 링 ×4

GRT-T10 Al. hinge pin (26mm)
₩2,500 알루미늄 힌지 핀 (26mm)

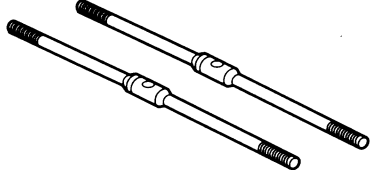
 ● 26mm Aluminum hinge pin 알루미늄 힌지 핀 ×2
 ● #2 E-ring 링 ×4

GRT-T11 Al. wheel hub (purple)
₩3,500 알루미늄 휠 허브 (퍼플)

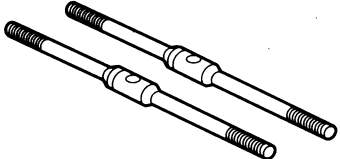
 ● Aluminum wheel hub 알루미늄 휠 허브 ×2

GRT-T12 Al. #4.3 pin ball (purple)
₩4,000 알루미늄 #4.3 핀볼 (퍼플)

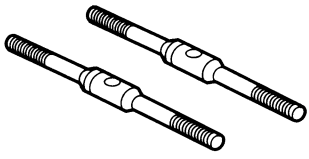
 ● Aluminum #4.3 pin ball 알루미늄 핀볼 ×5

GRT-T13 Al. Turnbuckle rod (65mm)
₩4,000 알루미늄 턴버클 로드 (65mm)

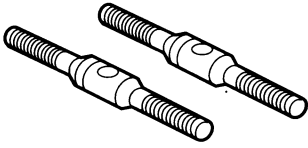
 ● 65mm Turnbuckle rod 턴버클 로드 ×2

GRT-T14 Al. Turnbuckle rod (52mm)
₩4,000 알루미늄 턴버클 로드 (52mm)

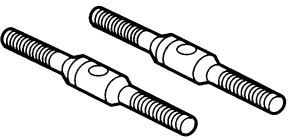
 ● 52mm Turnbuckle rod 턴버클 로드 ×2

GRT-T15 Al. Turnbuckle rod (42mm)
₩4,000 알루미늄 턴버클 로드 (42mm)

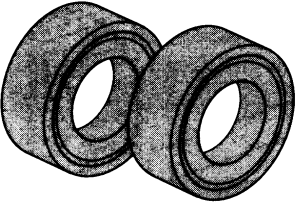
 ● 42mm Turnbuckle rod 턴버클 로드 ×2

GRT-T16 Al. Turnbuckle rod (34mm)
₩3,500 알루미늄 턴버클 로드 (34mm)

 ● 34mm Turnbuckle rod 턴버클 로드 ×2

GRT-T17 Al. Turnbuckle rod (26mm)
₩3,500 알루미늄 턴버클 로드 (26mm)

 ● 26mm Turnbuckle rod 턴버클 로드 ×2

WT-001 850 Ball bearing
₩6,000 850 볼 베어링

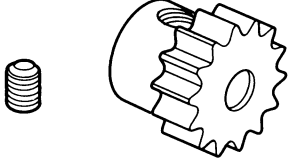
 ● 850 Ball bearing 볼 베어링 ×2

WT-002 1050 Ball bearing
₩7,000 1050 볼 베어링

 ● 1050 Ball bearing 볼 베어링 ×2

WT-10 Pinion gear (20T)
₩3,000 피니언 기어 (20T)

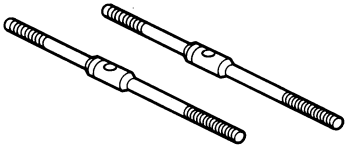
 ● 20T Pinion gear 피니언 기어 ×1
 ● #3×3 Set screw 육각 볼트 ×1

WT-14-A Turnbuckle rod (L52)
₩2,500 턴버클 로드 (L52)

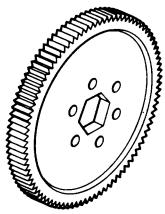

● L52 Turnbuckle 턴버클 로드 × 2

WT-15 Spur gear (82T)
₩3,500 스퍼 기어 (82T)



● 82T Spur gear 스퍼 기어 × 1

WT-16 Spur gear (83T)
₩3,500 스퍼 기어 (83T)

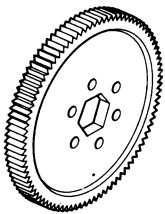

● 83T Spur gear 스퍼 기어 × 1

WT-17 Spur gear (85T)
₩3,500 스퍼 기어 (85T)

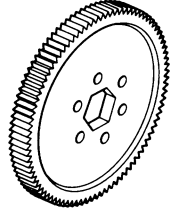

● 85T Spur gear 스퍼 기어 × 1

WT-18 Spur gear (87T)
₩3,500 스퍼 기어 (87T)

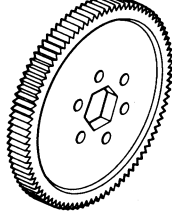

● 87T Spur gear 스퍼 기어 × 1

WT-22 Teflon clutch disk (pad)
₩1,500 테프론 클러치 디스크

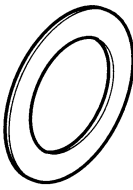

● Teflon clutch disk 테프론 클러치 디스크 × 1

WT-23 Thrust bearing set
₩2,000 트러스트 베어링 세트

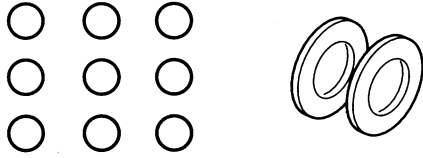

● Thrust ball 트러스트 볼 × 9
 ● Thrust washer 트러스트 와셔 × 2

WT-25 Ball diff. disk washer
₩1,000 디프용 디스크 와셔

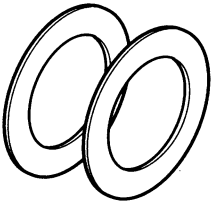

● Ball diff. disk washer 디프용 디스크 와셔 × 2

WT-26 ∅ 2.5 Diff. ball
₩2,000 ∅ 2.5 디프 볼

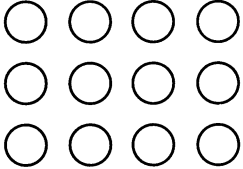

● ∅ 2.5 Diff ball 디프 볼 × 12

WT-32 Racer mini pin rear tire
₩9,000 레이서 미니핀 후륜 타이어

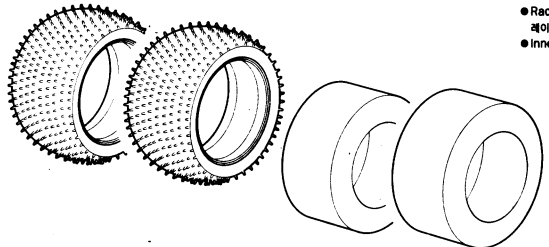

● Racer mini pin rear tire 레이서 미니핀 후륜 타이어 × 2
 ● Inner form 안나물 × 2

WY-44 1510 Ball bearing
₩14,000 1510 볼 베어링

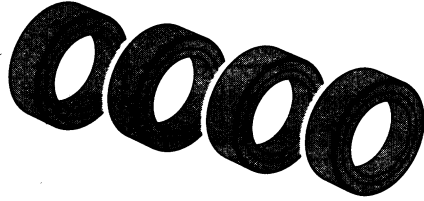

● 1510 Ball bearing 볼 베어링 × 4

AS-014 Oil damper set
₩1,500 오일 댐퍼 세트

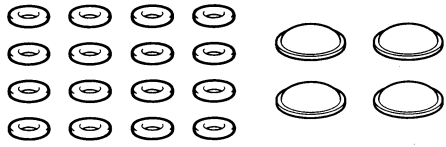

● Rubber cap 러버 캡 × 4
 ● Silicon O-ring 실리콘 O-링 × 16

AS-045 F/R diff. gear
₩6,000 디프 기어

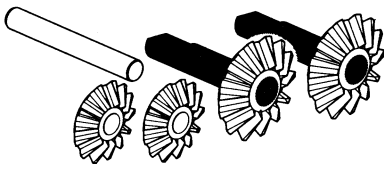

● 13T Bevel gear 베벨 기어 × 2
 ● 10T Bevel gear 베벨 기어 × 2
 ● ∅ 3 × 20 Shaft 샤프트 × 1

AT-018 1050 Ball bearing
₩22,000 1050 볼 베어링

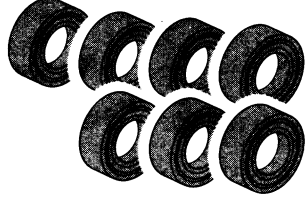

● 1050 Ball bearing 볼 베어링 × 7

■ 직매점 겸 A/S센터 삼선교: 742-9293, 대치동: 552-9293, 양재동: 575-9997, 용산: 706-9293
■ 총판점 겸 A/S센터 노원아카데미: 907-0940, 양천아카데미: 691-7108, 강남아카데미: 522-1577, 경기아카데미: (0343)458-5591,
 강북아카데미: 762-0980, 부산아카데미: (051)293-7449, 대구아카데미: (053)744-9293
■ A/S센터 본사: 908-7000(교환147), 동대문: 745-9293, 천호동: 473-9293
♣ 고객상담문의 : **080-969-7000**
★ 홈페이지 (HOME PAGE) **<http://www.academy.co.kr>**
 <http://www.academyhobby.com>

ACADEMY **ACADEMY PLASTIC MODEL CO., LTD.**
 HOBBY MODEL KITS 273-64, Suyu-dong, Kangbuk-gu, Seoul, Korea
 TEL: 82-2-908-7000 FAX: 82-2-997-3003