

Differential(Front, Rear) / Gear Differential(Vorne, Hinten) /
Diff rentiel(Avant, Arri re) / Diferencial(Delantero, Trasero) / デフギヤ(フロント/リヤ)

2.6 x 6mm TP F/H Screw
SK Treibschraube
Vis TP F/H 2.6x6mm
Tornillo 2.6x6mm TP F/H
TPサラビス

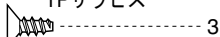

161 6 x 10 x 3mm Ball Bearing
Kugellager
Roulements ` billes
Rodamiento
ベアリング

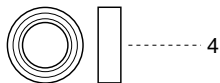

► Use Wrench Tool to tighten 2.6mm x 6mm screw.
Kreuzschlÿssel verwenden, um 2,6x6 mm Schraube festzuziehen.
Utiliser la cl en croix pour le serrage de la vis de 2.6mm X 6mm.
Utilice la llave de tubo para apretar el tornillo 2.6mm X 6mm.
レンチツールを使って2.6x6mmビスを締める。

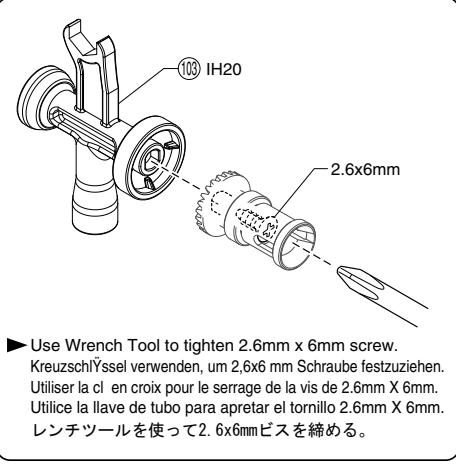
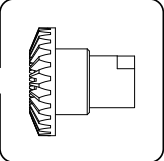
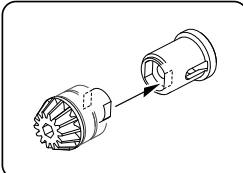
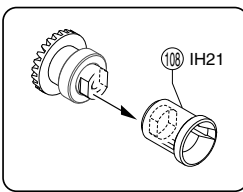
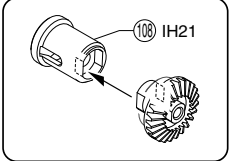
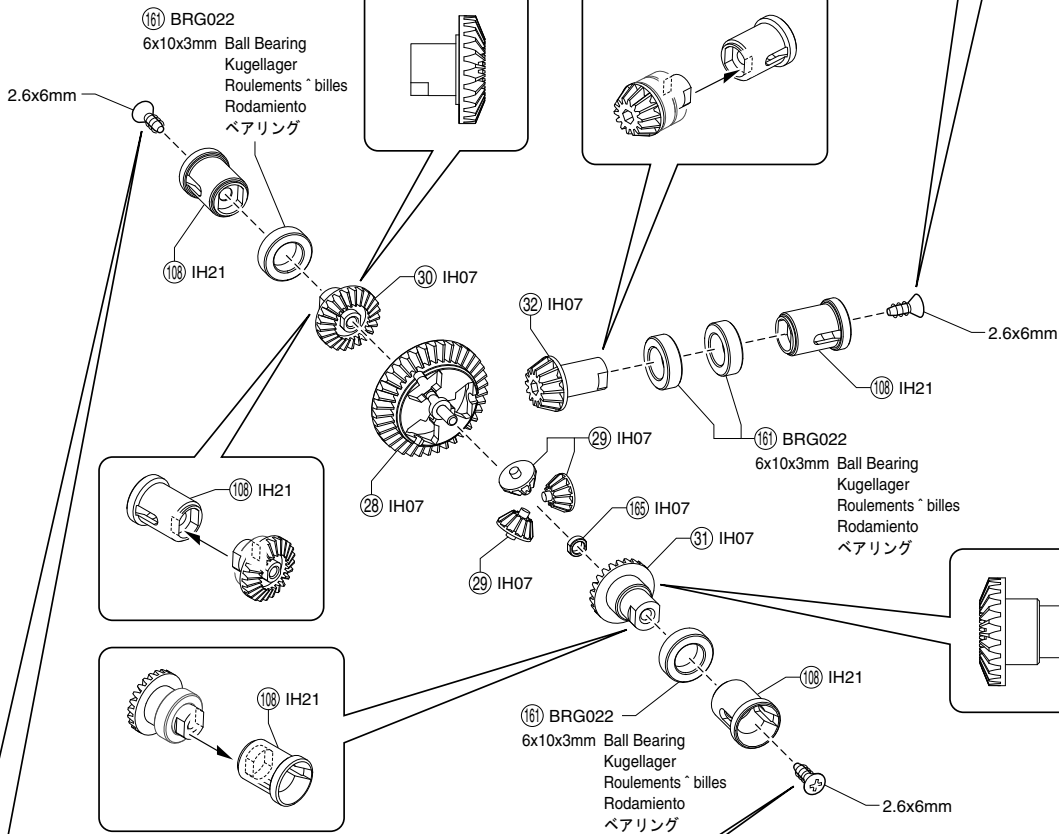
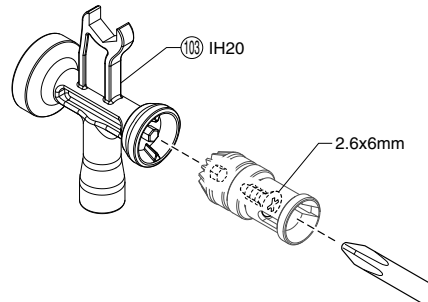

► Use Wrench Tool to tighten 2.6mm x 6mm screw.
Kreuzschlÿssel verwenden, um 2,6x6 mm Schraube festzuziehen.
Utiliser la cl en croix pour le serrage de la vis de 2.6mm X 6mm.
Utilice la llave de tubo para apretar el tornillo 2.6mm X 6mm.
レンチツールを使って2.6x6mmビスを締める。

Center Differential, Slipper Gear / Mitteldifferential und Rutschkupplung /
 Diff rentiel central & Slipper / Diferencial Central, Embrague / センターデフ, スリッパギヤ

2.6 x 6mm TP F/H Screw
 SK Treibschraube
 Vis TP F/H 2.6x6mm
 Tornillo 2.6x6mm TP F/H
 TPサラビス



157 4mm Nylon Nut
 Kunststoffmutter
 Ecrou nylon
 Tuerca Nylon
 ナイロンナット

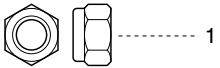

162 6 x 12 x 4mm Ball Bearing
 Kugellager
 Roulements ` billes
 Rodamiento
 ベアリング

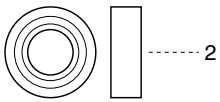

163 4 x 7 x 2.5mm Ball Bearing
 Kugellager
 Roulements ` billes
 Rodamiento
 ベアリング

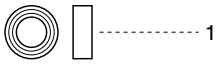

123 4 x 7 x 2.5mm Metal Bushing
 Lager
 Bague M tal 4x7x2.5mm
 Casquillo Metálico 4x7x2.5mm
 メタルブッシュ

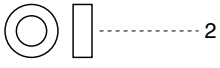

164 3 x 6 x 2.5mm Ball Bearing
 Kugellager
 Roulements ` billes
 Rodamiento
 ベアリング

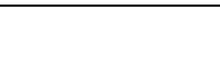
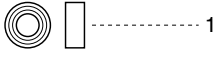

► Use Wrench Tool to tighten 2.6mm x 6mm screw.
 Kreuzschlüssel verwenden, um 2.6x6 mm Schraube festzuziehen.
 Utiliser la clé en croix pour le serrage de la vis de 2.6mm X 6mm.
 Utilice la llave de tubo para apretar el tornillo 2.6mm X 6mm.
 レンチツールを使って2.6x6mmビスを締める。

< Center Differential >
 < Mitte Gear Differential >
 < Diff rentiel Central >
 < Diferencial Central >
 < センターデフ >

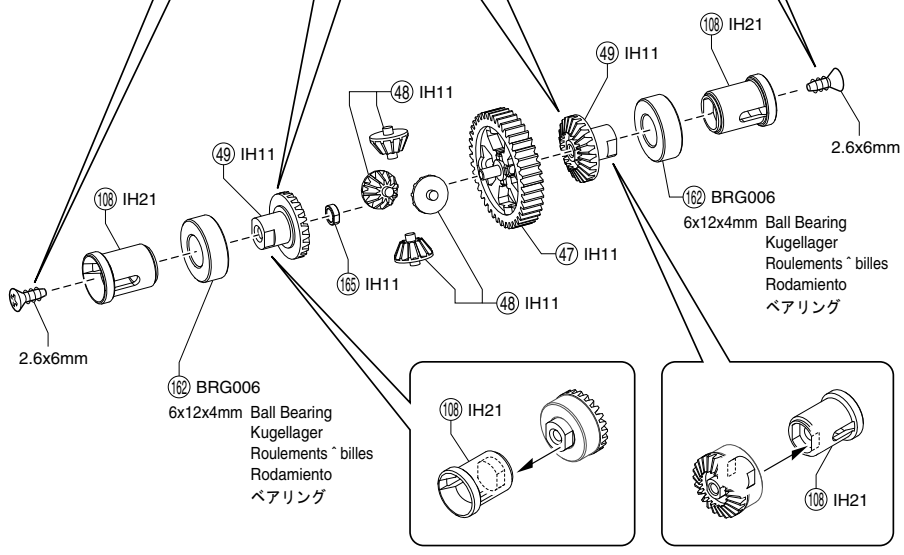

< Slipper Gear >
 < Rutschkupplung >
 < Couronne de slipper >
 < Embrague >
 < スリッパギヤ >

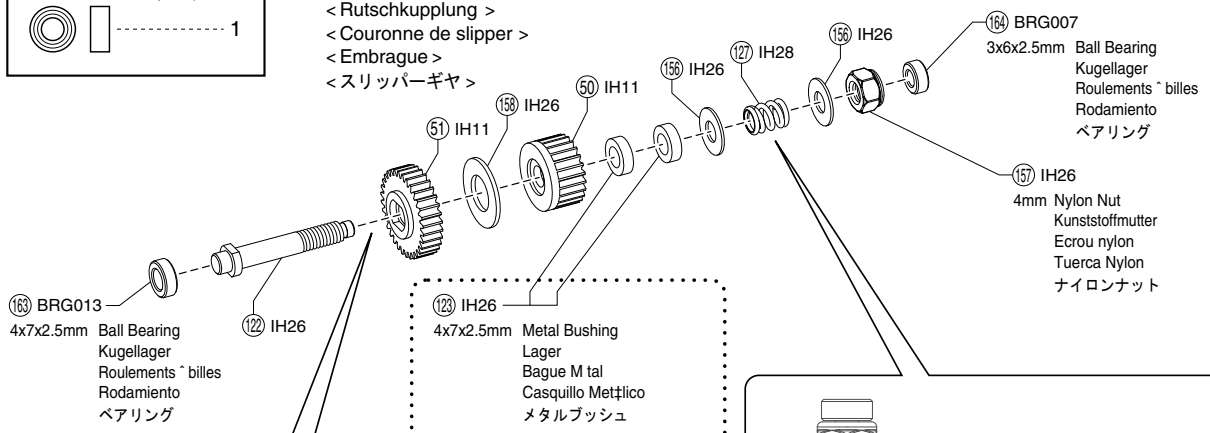

163 BRG013 4x7x2.5mm Ball Bearing
 Kugellager
 Roulements ` billes
 Rodamiento
 ベアリング

122 IH26 4x7x2.5mm Metal Bushing
 Lager
 Bague M tal
 Casquillo Metálico
 メタルブッシュ

*Optional ball bearings (No.BRG013) can be used here.
 *Als Tuning können die Kugellager Best.-Nr. BRG013 verwendet werden.
 *Remplacer les bagues m tal par l'option roulements ` billes (R f. BRG013).
 *Puede instalar rodamientos opcionales (No.BRG013).
 *オプションのベアリング (No. BRG013, ¥1050)が使用できます。

► 4mm - 5mm (refer to P.23).
 Das Spaltmaß muss zwischen 4mm und 5mm betragen!
 4mm - 5mm (voir P.23).
 M'nimo 4~5mm (ver P.23).
 4mm~5mm (P23参照)

Shock Absorber / Stoßdämpfer /
Amortisseurs / Amortiguador / ダンパーユニット

For Front / Vorne
/ Avant / Delanteros
/ フロント用

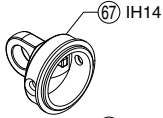

For Rear / Hinten
/ Arri re / Traseros
/ リヤ用

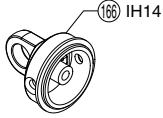

For Front / Vorne
/ Avant / Delanteros
/ フロント用

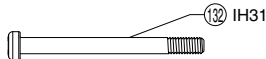

For Rear / Hinten
/ Arri re / Traseros
/ リヤ用

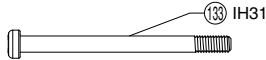

▶ Maintain and clean regularly.
Regelmäßig warten und säubern!
Entretien et nettoyage réguliers
Limpiar periódicamente.
定期的に汚れを取ります。

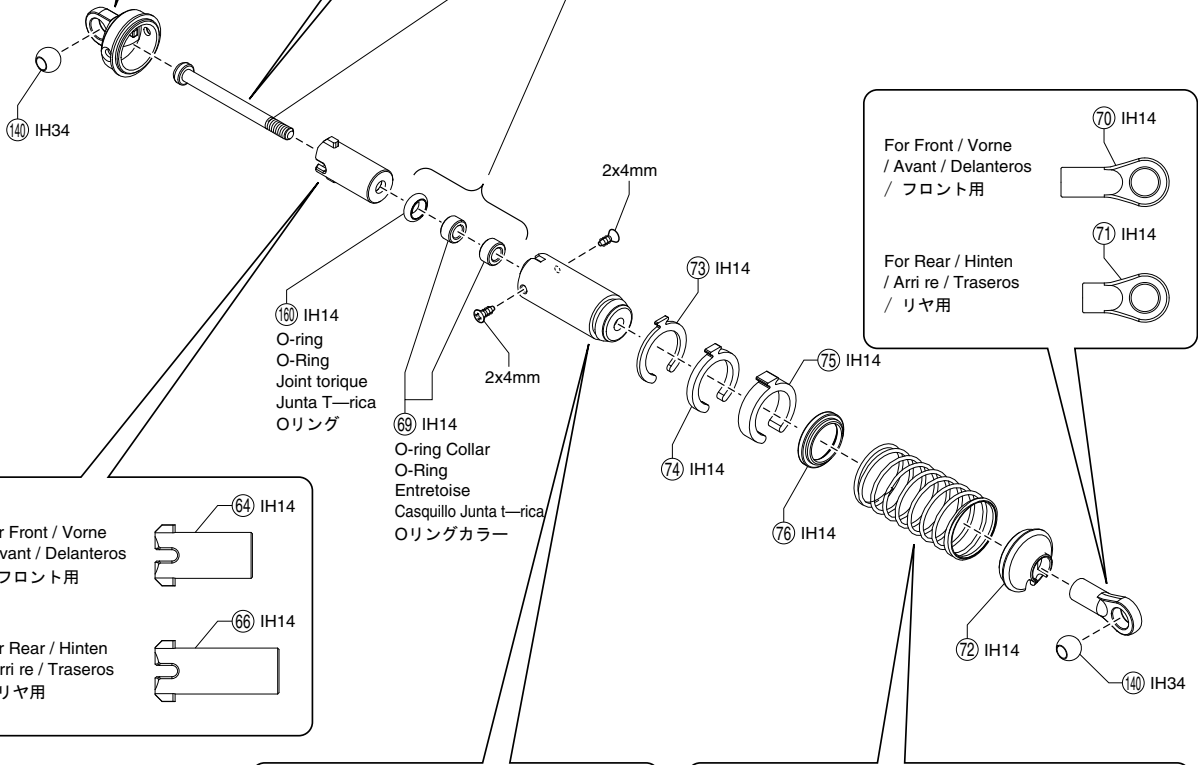

For Front / Vorne
/ Avant / Delanteros
/ フロント用

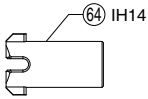

For Rear / Hinten
/ Arri re / Traseros
/ リヤ用

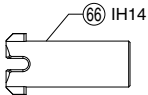

2 x 4mm TP F/H Screw
SK Treibschraube
Vis TP F/H 2x4mm
Tornillo 2x4mm TP F/H
TPサラビス

8

160 O-ring
O-Ring
Joint torique
Junta T—rica
Oリング

4

69 O-ring Collar
O-Ring
Entretoise
Casquillo Junta T—rica
Oリングカラー

8

For Front / Vorne
/ Avant / Delanteros
/ フロント用

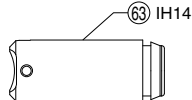

For Rear / Hinten
/ Arri re / Traseros
/ リヤ用

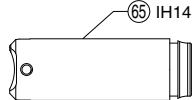

For Front / Vorne
/ Avant / Delanteros
/ フロント用

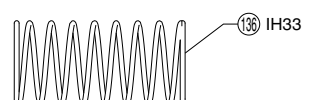

For Rear / Hinten
/ Arri re / Traseros
/ リヤ用

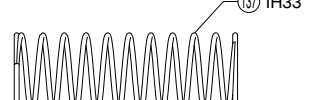

For Front : 16mm
Vorne : 16mm
Avant : 16mm
Dela nteros : 16mm
フロント用 : 16mm

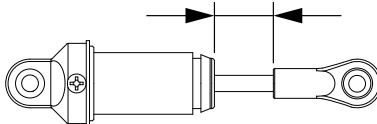

For Rear : 21mm
Hinten : 21mm
Arri re : 21mm
Traseros : 21mm
リヤ用 : 21mm

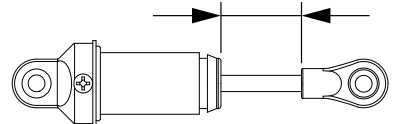

Steering / Lenkung /
Direction / Direzione / ステアリングユニット

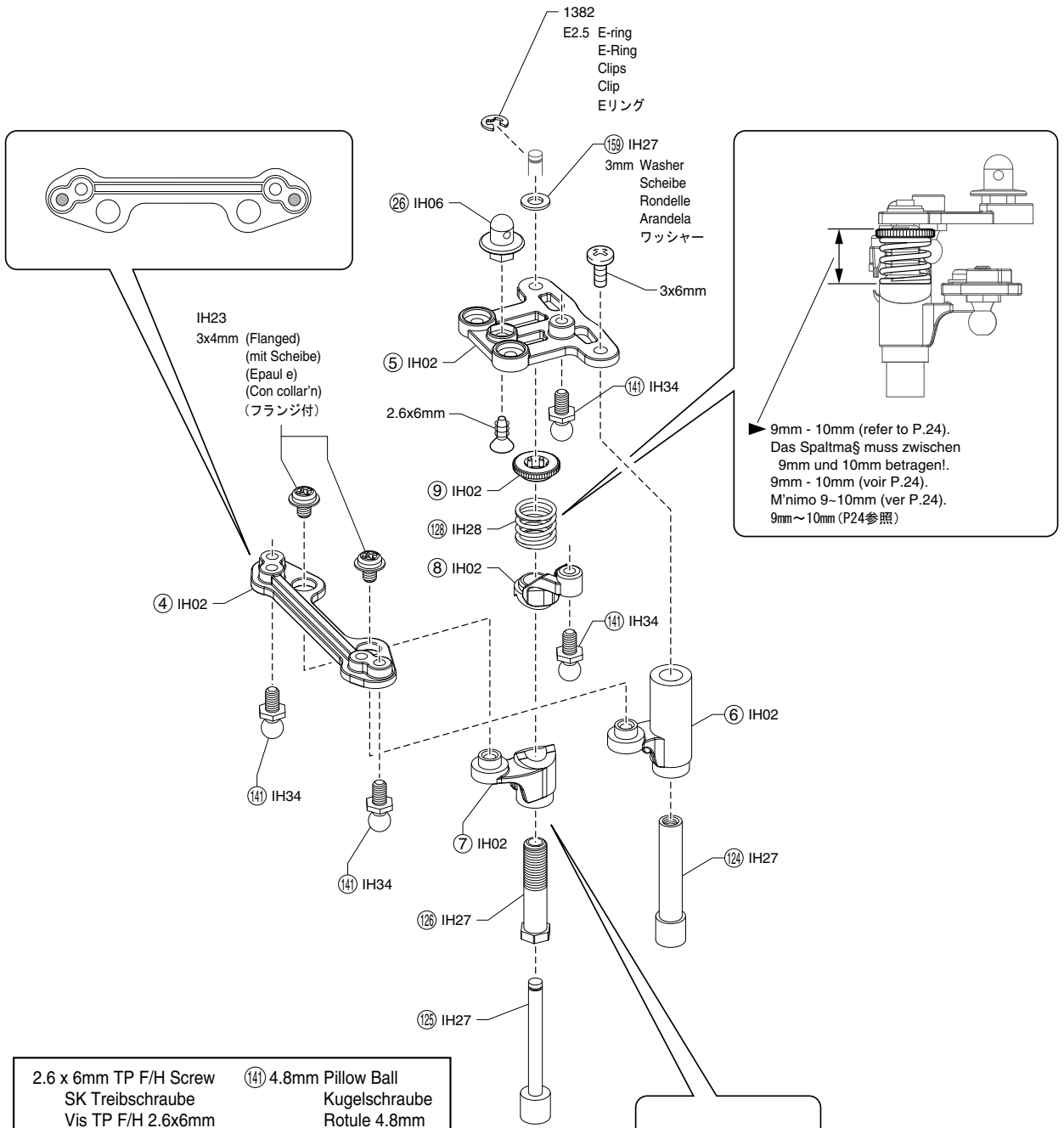

- | | | | |
|--|---|---|---|
| 2.6 x 6mm TP F/H Screw
SK Treibschraube
Vis TP F/H 2.6x6mm
Tornillo 2.6x6mm TP F/H
TPサラビス | 1 | 141 4.8mm Pillow Ball
Kugelschraube
Rotule 4.8mm
R-tula 4.8mm
ピロボール | 4 |
| 3 x 6mm Screw
LK Schraube
Vis 3x6mm
Tornillo 3x6mm
ビス | 1 | E2.5 E-ring
E-Ring E2.5
Clips 2.5mm
Clip E2.5
Eリング | 1 |
| 3 x 4mm Screw (Flanged)
Schraube (mit Scheibe)
Vis 3x4mm (Epaule)
Tornillo 3x4mm (Con collar'n)
ビス (フランジ付) | 2 | 159 3mm Washer
Scheibe
Rondelle 3mm
Arandela 3mm
ワッシャー | 1 |

